

Claiming parent account (to access Infinite Campus through ID portal)

Go to <https://id.pausd.org> (You can also go to <https://paly.net>, hover over **Connect** and then select **“ID Student/Staff/Parent Portal”**.)

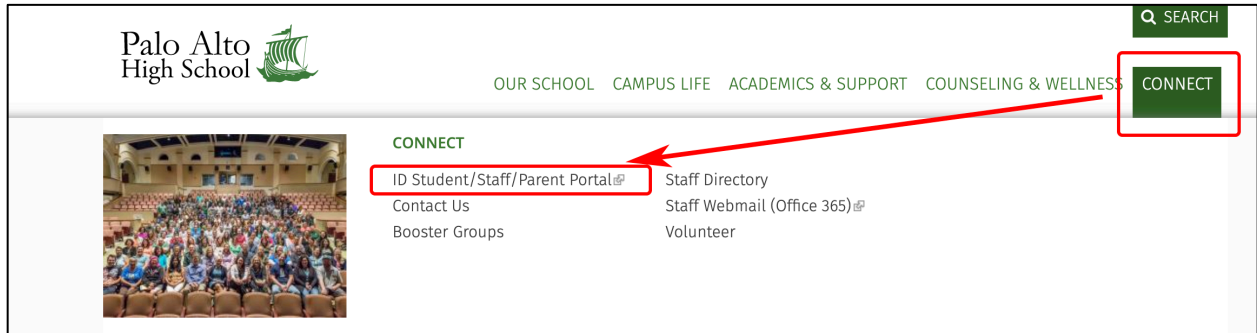

Click on **Claim Parent Account**. (This is a one-time process.)

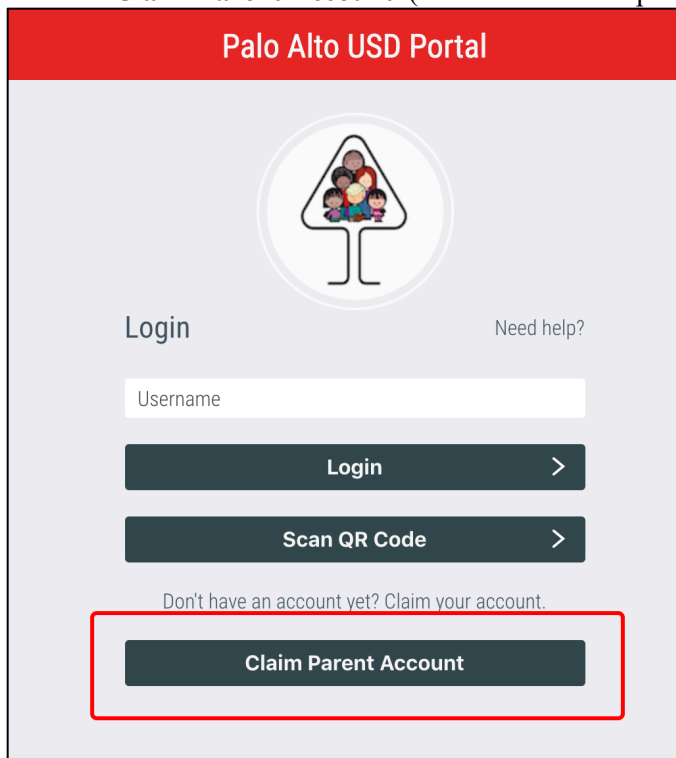

Claiming parent account (to access Infinite Campus through ID portal)

If you have multiple children, you only need to use one student ID number to claim your parent account. You will see your other children listed once you finish this process.

Claim Account



Step 1

Answer the following questions to claim your account:

Parent First Name: *

Parent Last Name: *

Parent email address on file with PAUSD: *

Student number for one child in your household (e.g. 95012345): *

Next 

Powered by Identity Automation